



The Hen Hoose, Dounby, KW17 2HP

Offers Over £280,000



ALLAN PROPERTIES



The Hen Hoose The Hen Hoose

Dounby, KW17 2HP

- DETACHED 2 BEDROOM BUNGALOW
- 2 EN-SUITE BATHROOMS
- STYLISH OPEN-PLAN LIVING
- VIRTUAL TOUR AVAILABLE ON OUR WEBSITE
- STUNNING COUNTRYSIDE VIEWS
- MOVE-IN CONDITION
- WHAT3WORDS LOCATION: listening;yield;nice
- CONTACT THE OFFICE TO BOOK A VIEWING

Welcome to the Hen Hoose, a beautifully presented 2 bedroom bungalow currently being run as a holiday let. The Hen Hoose is in an excellent location, close to the West Mainland village of Dounby and the West Mainland of Orkney Neolithic sites. This stylish property offers the opportunity to purchase a turnkey holiday let with stunning country views in an ideal location for visitors wishing to experience Orkney's world renowned historic sites.

Accommodation is well laid out and comprises a modern, open-plan kitchen, dining and living room with wood-burning stove and double doors leading to the garden; two bright, comfortable double bedrooms with contemporary ensuite bathrooms and a WC. There is a plant/store room adjoining the property, ample parking and a generous, low maintenance garden around the property laid to lawn.





Directions





Floor Plans

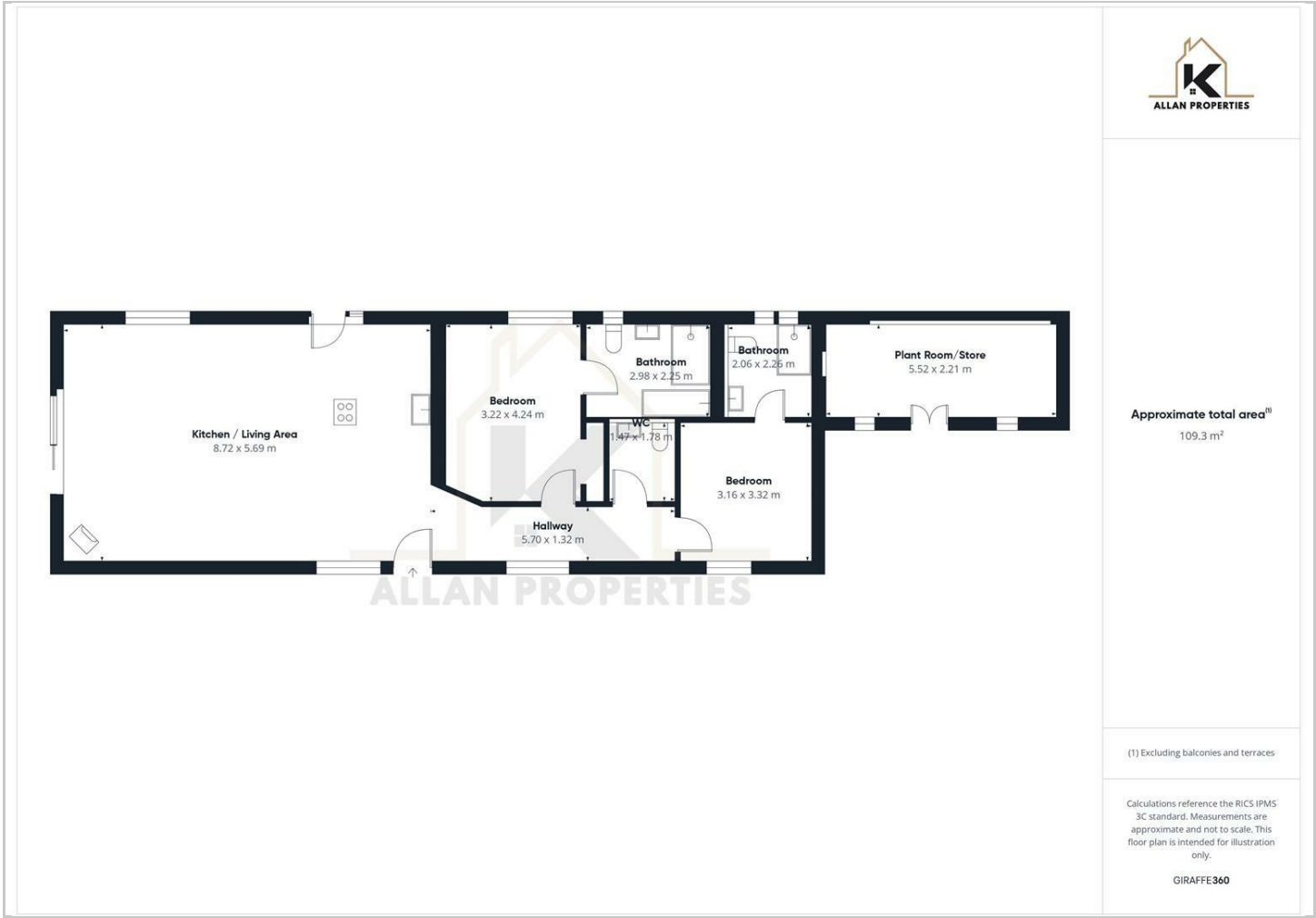

Viewing

Please contact our K Allan Properties Office on 01856 876377 if you wish to arrange a viewing appointment for this property or require further information.

The particulars are set out as a general outline only for the guidance of intended purchasers or lessees, and do not constitute, any part of a contract. Nothing in these particulars shall be deemed to be a statement that the property is in good structural condition or otherwise nor that any of the services, appliances, equipment or facilities are in good working order. Purchasers should satisfy themselves of this prior to purchasing.

Watergate, Kirkwall, Orkney, KW15 1PD
Tel: 01856 876377 Email: info@kallanproperties.co.uk <https://www.kallanproperties.co.uk>

Location Map



Energy Performance Graph

